

MORGAN PRODUCTS

PNEUMATIC CHEMICAL PUMPS FOR THE GAS AND OIL INDUSTRIES

MODEL 55DS-TR2

AIR ACTUATED POSITIVE DISPLACEMENT PUMP

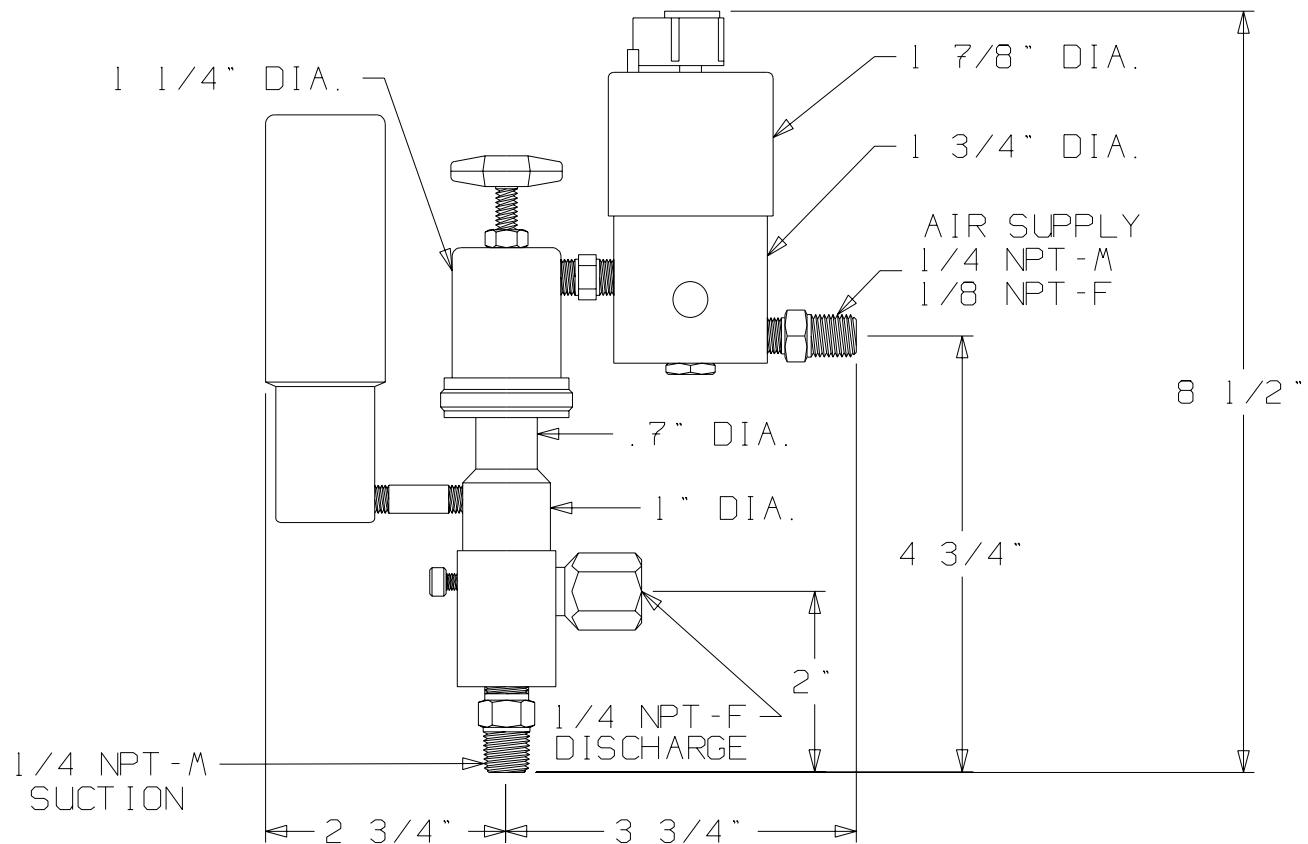

Net Weight 5 Pounds
2.3 Kilograms

MODEL (WITH TIMER)	PUMP DISPLACEMENT	PUMP RATIO	STROKE LENGTH in. - cm.	CONNECTIONS ALL NPT INPUT / OUTPUT	MAXIMUM DISCHARGE PSI - BAR	OUTPUT PER HOUR GAL. / LTS.
55DS -TR2	.2 cc	54:1	3/4 - 1.91	1/4 - M / 1/4 - F	8100 - 558	.01 - .12 / .05 - .46

MORGAN PRODUCTS INC. 28103 Ave. Stanford / Valencia, CA 91355

(661) 257-3022 - (800) 421-8910 - FAX (661) 257-3385
www.morganproducts.com - E-Mail info@morganproducts.com

MORGAN PRODUCTS

PNEUMATIC CHEMICAL PUMPS FOR THE GAS AND OIL INDUSTRIES

Parts List Model 55DS

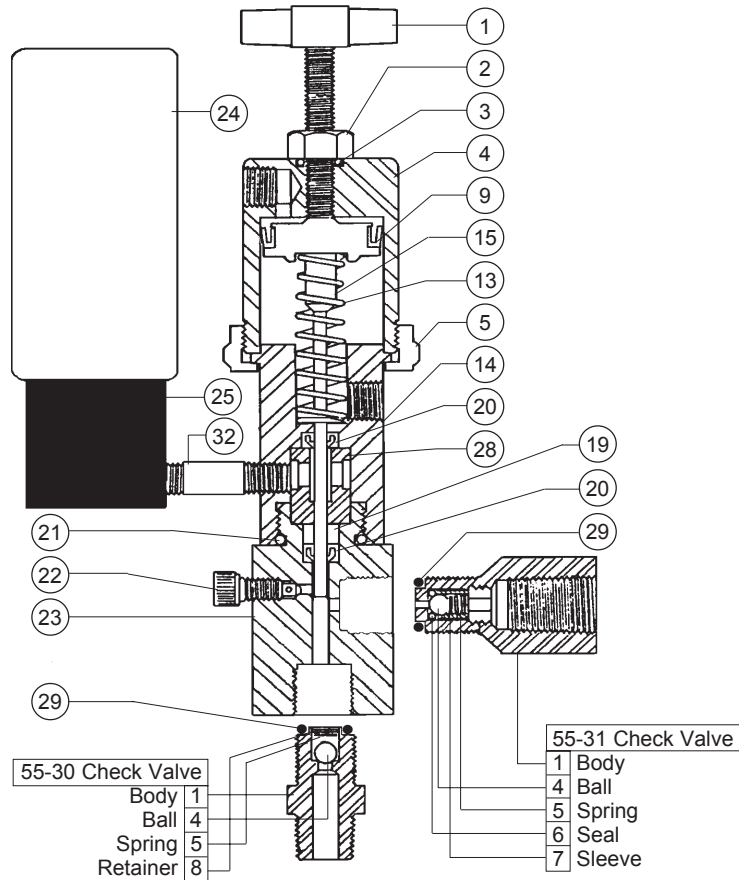

NO	NAME	PART NO.
1	Stroke Adjuster	50-1
2	Locknut	50-2
3	O-Ring Seal	100-11 *
4	Air Chamber	50-4
5	Chamber Ring	50-5
9	Piston Seal	50-9 *
13	Return Spring	50-13 *
14	Oil Chamber	55-14
15	Plunger 17-4TN	50-15 *
	Optional Material Plunger 316 SS	55-17
19	Back-up Ring	50-19 *+
20	Pressure Seal	50-20 *+(2)
21	O-Ring	50-21 *
22	Bleeder	50-22
23	Fluid Chamber	55-23
24	2 oz. Oil	100-24 *
25	Reservoir	100-25
28	Seal Retainer	50-28
29	Check Valve Seal	50-29 * (2)
32	Nipple	100-32
	1oz. Grease	*
	Repair Kit:	
	W/ 17-4TN Plunger	50-50
	W/ 316 SS Plunger	55-50
	Seal Sets:	
	TG	50-48
	Buna-N	50-48B
	Viton	50-48V
	Fluoraz	50-48F

* = Included in Repair Kit

+ = Included in Seal Set

INSTALLATION INSTRUCTIONS

1. Discard all red plastic closures.
2. Connect suction check valve, to a gravity fed chemical.
3. Connect discharge check valve, to process line.
4. Connect a regulated air or gas supply, to the timing relay
5. Fill oil reservoir with oil provided.
6. Open bleeder valve until chemical flows from bleeder.
7. Set regulator at 10 - 15 psi ABOVE the pressure required (See discharge pressure graph).
8. Set cycle rate in strokes per minute (See volume graph).

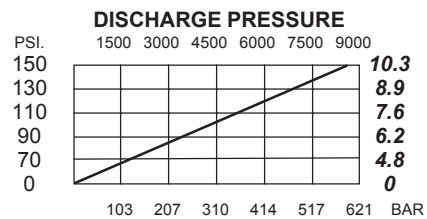
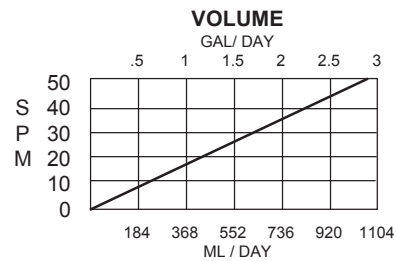

MORGAN PRODUCTS INC. 28103 Ave. Stanford / Valencia, CA 91355

(661) 257-3022 - (800) 421-8910 - FAX (661) 257-3385